

	BUILT-IN COMBI 3320	CUSTOMER SUPPORT
	ASSEMBLE & DISASSEMBLE	

Changing The Door Swing Direction to Right Hand

1- Unscrew the two screws fixing the top hinge (Fig-1) and remove the freezer door. (Fig-2)

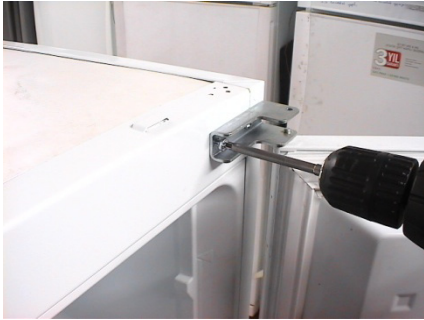

Figure 1



Figure 2

2- Unscrew the two screws fixing the middle hinge side bracket and remove it. (Fig-3)



Figure 3

3- Unscrew the two screws fixing the middle hinge (Fig-4) and remove the refrigerator door. (Fig-5)



Figure 4



Figure 5

4- Remove the bottom hinge pin (Fig-5) and insert it to the left side foot. (Fig-6)



Figure 5



Figure 6

5- Unscrew the middle hinge side bracket on the left and remove it. (Fig-7)
Remove the middle hinge screw caps (big) on the left side.



Figure 7

6- Assemble the refrigerator door. Rotate the middle hinge by 180° and screw it to the left side. (Fig-8) Then screw the middle hinge side bracket on the middle hinge. (Fig-9)



Figure 8



Figure 9

	BUILT-IN COMBI 3320	CUSTOMER SUPPORT
	ASSEMBLE & DISASSEMBLE	

7- Remove the top hinge screw caps (big) on the left side (Fig-10) and insert them to the right side. (Fig-11) (You can find the new caps in the user manual bag)



Figure 10



Figure 11

8- Unscrew the pin of the hinge from Hole 1, rotate the top hinge by 180° and screw the pin to Hole 2. (Fig-12)

9- Assemble the freezer door and screw the top hinge to the left side. (Fig-13)

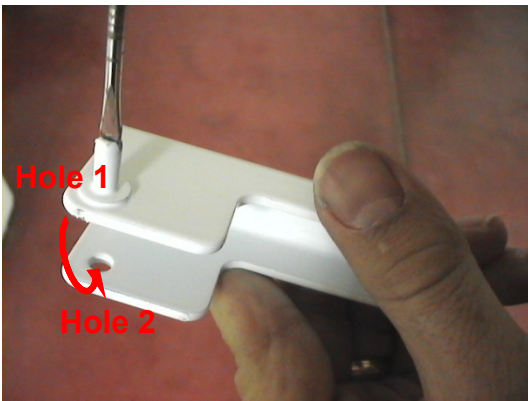

Figure 12



Figure 13

10- Screw the middle hinge side bracketed on the right of refrigerator. (Fig-14) and insert the middle hinge screw caps (big) on the right side. (Fig-15) (You can find the new caps in the user manual bag)



Figure 14



Figure 15

